

# 6902 Trench Grate

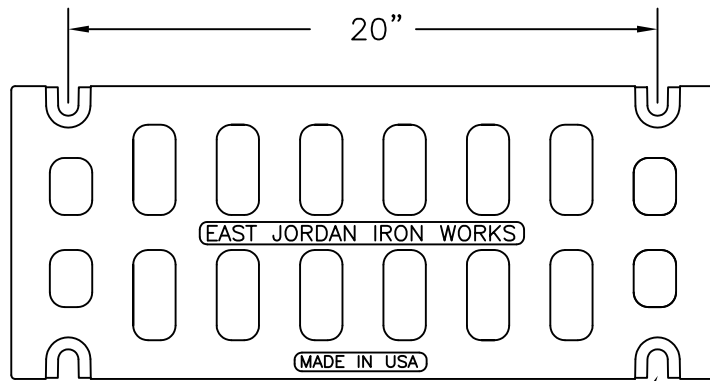

(4) CORED SLOTS  
FOR BOLTING

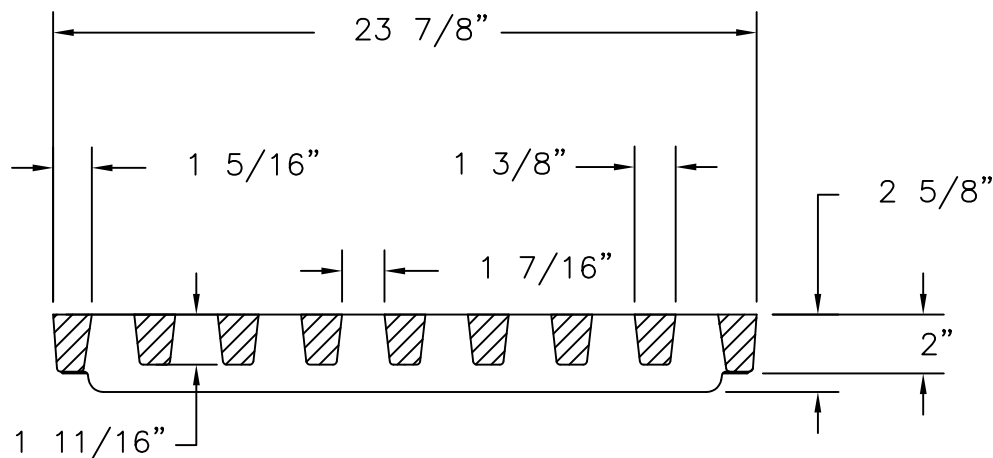

SECTION

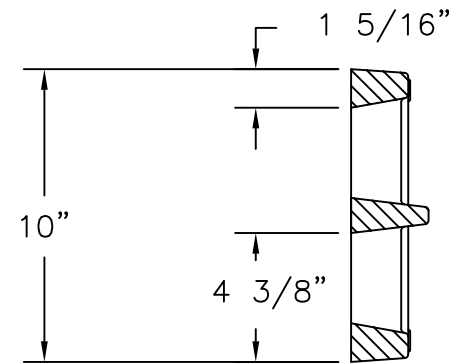

SECTION

**Product Number**

00690242

**Design Features**

- Materials  
Gray Iron (CL35)
- Design Load  
Heavy Duty
- Open Area  
60 SQ. IN.
- Coating  
Undipped
- ✓ Designates Machined Surface

**Certification**

- ASTM A48
- 
- Country of Origin: USA

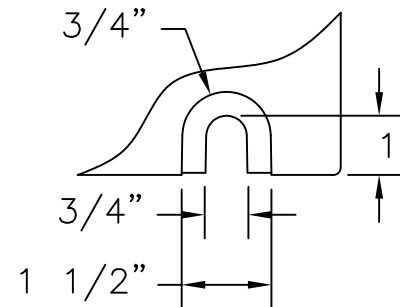

SLOT PLAN

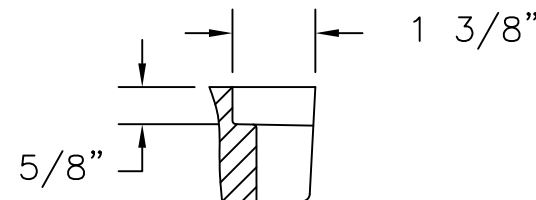

SLOT SECTION

Supplied By:

**TRENCHDRAIN  
SUPPLY**

877-903-7246

www.trenchdrainsupply.com

**Drawing Revision**

08/19/2004 Designer: KPM

03/29/2012 Revised By: SDC

**Disclaimer**

Weights (lbs./kg) dimensions (inches/mm) and drawings provided for your guidance. We reserve the right to modify specifications without prior notice.

CONFIDENTIAL: This drawing is the property of EJ GROUP, Inc., and embodies confidential information, registered marks, patents, trade secret information, and/or know how that is the property of EJ GROUP, Inc. Copyright © 2011 EJ GROUP, Inc. All rights reserved.

**Contact**

800 626 4653  
ejco.com